



CAUTION

Read This Instruction Before Installation

1 The Air Outlet & Inlet Side for Two Different Ducted Types:

For Medium Static Pressure Models:



For High Static Pressure Models:



2 How to Connect the Wired Controller and Display Board to PCB:

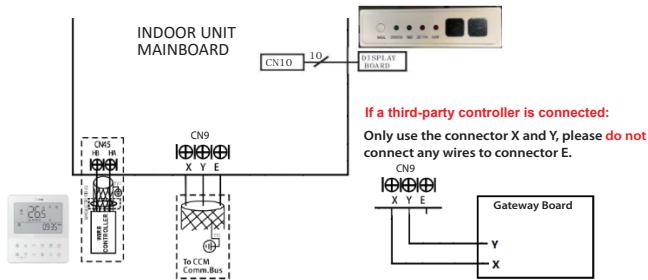

3 About the water pump:

We suggest to use a water pump to drain water. If you want to use water pan drainage instead, please use a short connection wire to connect CN5 to disable the water level sensor. Then unplug CN13 to disable the water pump.

(Warning: It may cause condensation or water blow out without using a water pump)

5 How to Set Static Pressure Value after Installation on the Wired Controller:

Automatic Airflow Adjustment (Recommend)



When the air conditioning unit is off, into the query function of temperature, press " \wedge " or " \vee " to select AF, press "Confirm" into test mode, press "Back" or press "ON/OFF" or press "Confirm" drop out of test mode. In AF mode, 3~6 minutes test completion automatically exits, if the test process, press "Back" or press "ON/OFF" or press "Confirm", the test exits will be interrupted.

Manually Set Static Pressure

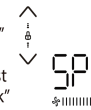

When the air conditioning unit is off, into the query function of temperature, press " \wedge " or " \vee " to select SP, press "Confirm" to adjust the static pressure value.

6 How to Separate & Assemble the 17kW IDU:

Separate

1. Remove the E-control box cover.
2. Unplug the water pump cable, water level cable and temperature sensor cable.
3. Remove 6 screws from the left side to unscrew the connection plate, and remove 3 screws from the right side and 6 screws from the top.

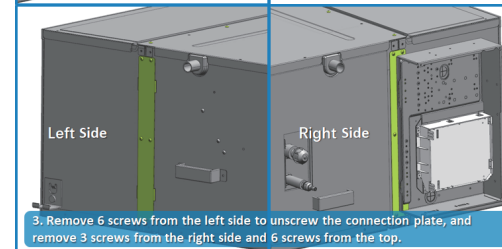
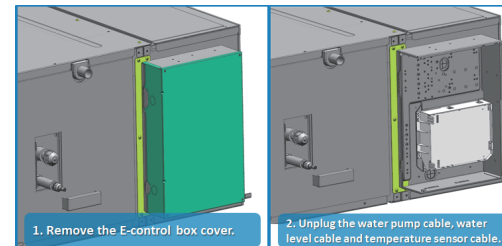

Assemble

1. **Turn over** the two separated sections and connect cables.
2. Screw the connection plate back and assemble the unit.

Attention: The 6 screws removed from the previous top (now it is the bottom) should be re-installed on the current top.

4 How to Fix the Display Board:

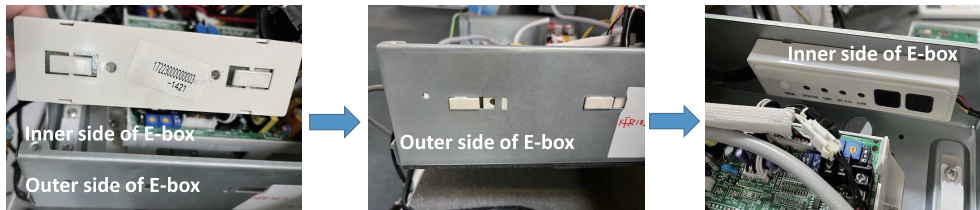

1. Find the clips at the back of the display board and the E-box.
2. Place the display board inside the E-box, align the clips and stuck them together.
3. Check if the display board is fastened.

CAUTION

Read This Instruction Before Installation

1 How to Connect the Indoor & Outdoor Wire:

Indoor & Outdoor Connection (7kW) Indoor & Outdoor Connection (9kW and above)

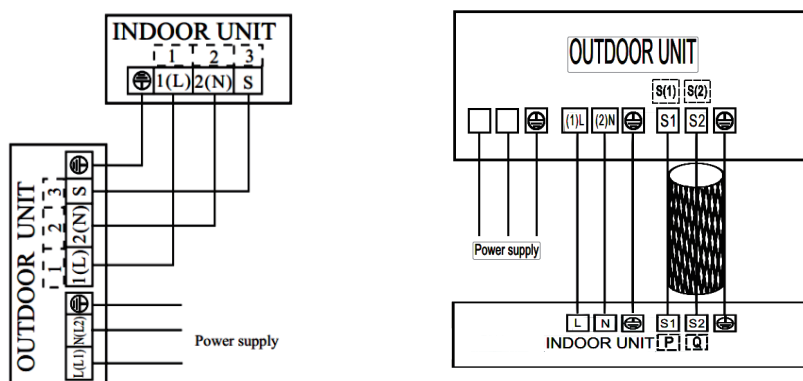

2 About the Refrigerant Charge Amount:

Connection Pipe Length (m)	Additional Charge Amount (g)
<20	0
>20	(Pipe Length-20m)*24

3 For Capacity >12.5kW Models:

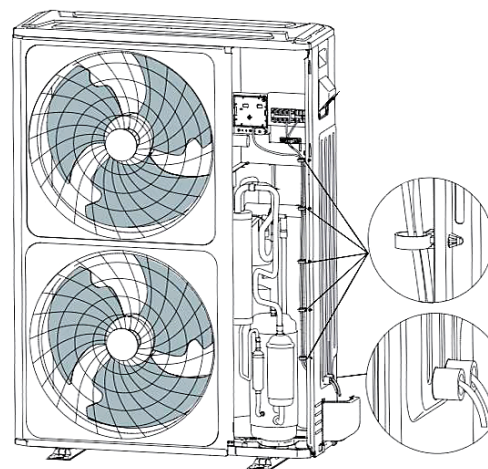

Please prepare spanner and flat-blade screwdriver before your installation work .

1. Remove two fixing screws, then remove the front panel.
2. Use spanner and flat-blade screwdriver to knock down two metal seals, then pick the metal flakes out.

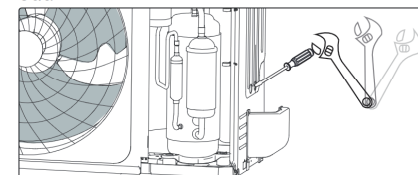

3. Connect the power cable and indoor & outdoor connection cable. Clamp down the cable with the cable clamp.
4. The wire groups shall be bound with cable ties and fixed on the right side plate after they are connected. The strong electric wire group and weak electric wire group shall be led out separately through the two knock down holes on the bottom of the right side plate and fastened with a locking connector as shown in the figure below.



Do not open this handle for wiring.

Open two knock-down holes for wiring.
Please find the wiring instruction above.