

The diagram above is just for reference. Please take the appearance of the actual product as the standard.

ULTRAFILTRATION WATER PURIFIER

Instruction Manual

Model: MUSP4W

Before installing and operating your water purifier, please read the instruction manual carefully and keep it for future reference.

Contents

A. Product Overview.....	2
B. Display Instructions.....	2
C. Use it for the First Time.....	3
D. Usage Cautions.....	4
E. Filter Configuration.....	7
F. Filter Replacement.....	8
G. Basic Parameters.....	8
H. Daily Maintenance.....	8
I. Water treatment process drawing.....	9
J. Check the Abnormal Phenomenon.....	9

A. PRODUCT OVERVIEW

This device is used for filtering and purifying municipal tap water, and the output water quality meets the "Sanitary Standard for Hygienic Safety and Function Evaluation on Treatment Devices of Drinking Water --- General Water Treatment Device". It is suggested to use the purified water produced by this device for household use (braising soup, cooking rice, washing vegetable).

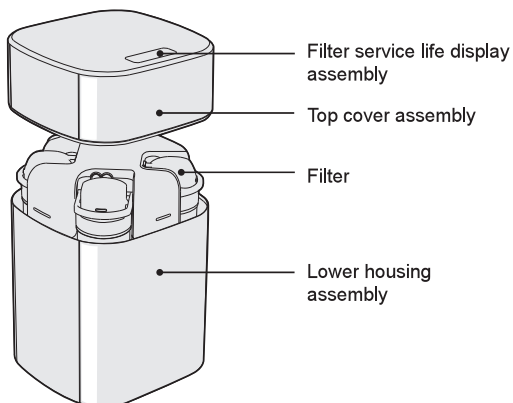

Instructions



1/4" PE pipe
(standard configuration
for down type)

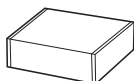

Faucet accessories box



Water outlet faucet

Remarks:

The faucet accessories box composes of: gooseneck faucet: 1 set, water inlet ball valve: 1 pcs, 2" joint clamp: 8 pcs.

B. DISPLAY INSTRUCTIONS

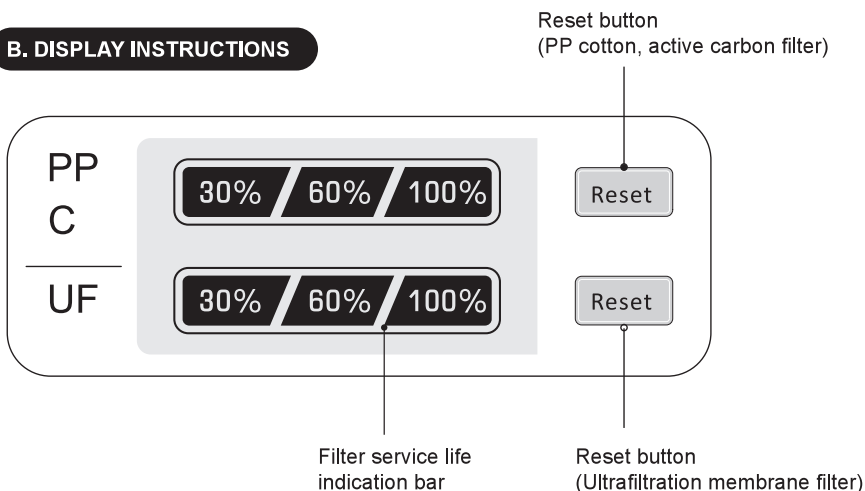

C. USE IT FOR THE FIRST TIME

Start/Stop the Device for Undersink

The water purifying device should be installed by the professional technicians of local service office.

1.Dial your local customer service to reserve water purifier installation

2. The installation technician shall install, flush and test the device according to the steps listed in the Installation and Maintenance Manual

3. Users may normally use the water purifier

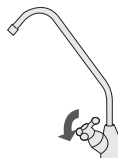
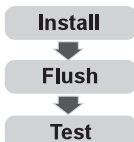

1.Connect with water source,install the 1/4" tubing on the valve, turn on the three-way ball valve, supply tap water.

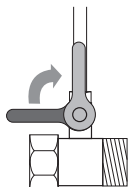

2.Connect tubing with three-way ball valve to the " Water In" port of the system.



3.Install quick-fitting to the faucet.
4.Connect tubing with faucet to the " Water Out" port of the system.



5. Turn on the faucet, water purifier starts to produce water, close the faucet and the device stops producing water

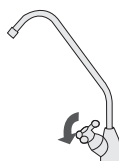

Note:

1. If it will be kept at OFF state for a long period, it is suggested to close the three-way ball valve.
2. Make sure you remove the Lock Clip when inserting the tubing. Reinstall the Lock Clip after the tubing is inserted.

Start/Stop the Device for Desktop

Note:The faucet supply 4 different screws,if the screw does not fit your tap, please contact your local plumbing supply center where adapters are available for purchase.

1. Select the suitable screw, connect the supply faucet with your tap, cut the PE pipe as you need, insert PE pipe to faucet white fitting with purifier inlet, insert PE pipe to faucet blue fitting with purifier outlet.Turn on the faucet supply tap water.
2. Turn on the diverter valve, water purifier starts to produce water
- 3.Turn off the divertor valve to the below direction,shut off the water. Meanwhile you can turn off the faucet

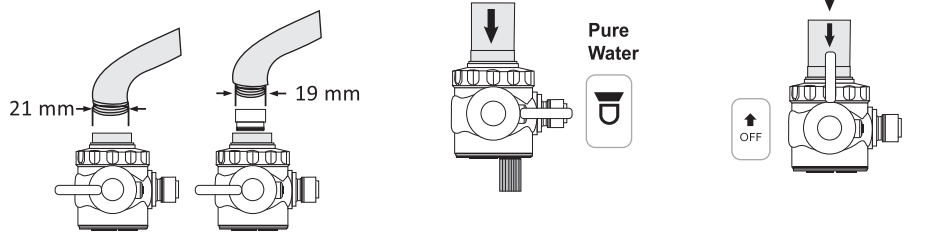

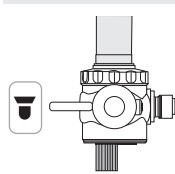
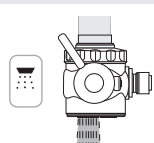
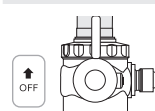
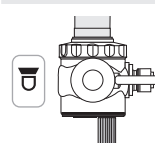
Smart Just 1 Turn	Raw Water	Spay Water (Tap Water)	Turn Off	Pure Water (Filtered Water)
				

D. USAGE CAUTIONS

In order to ensure safe use and prevent physical injury and property loss for you and others, please obey the following cautions, otherwise, it may possibly cause accident.

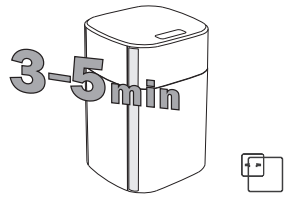
- 

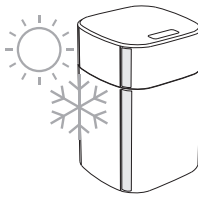
❗ If this device won't be used for a long period, please cut off power supply and close the three-way ball valve. When using it again, please discharge water for 3-5min before normal use.
- 

⚠ Do not store it in the place with direct and intensive sunlight, otherwise, it may easily cause components ageing. avoid store or expose the device in the environment lower than 0 °C.

In order to ensure safe use and prevent physical injury and property loss for you and others, please obey the following cautions, otherwise, it may possibly cause accident.

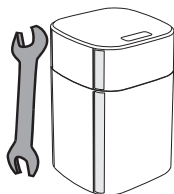

- ❗ The device must be installed or relocated by professional technician, it will easily damage the product or cause the danger of electric shock if the components of the device are dismantled by yourself, it will easily cause improper operation if the device is moved or conveyed by yourself, which may result in device damages.

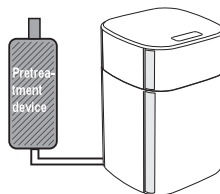

- ❗ Pretreatment device shall be installed in front of this device if the inlet water doesn't meet the standard of municipal tap water (high content of mud and sand in water, residual chlorine exceeds the standard).

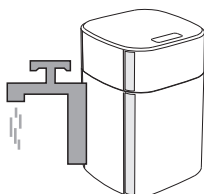

- ❗ The best working pressure of this device ranges 0.1-0.4MPa, please install corresponding pressure increasing or decreasing device if the water pressure is higher or lower than this level.

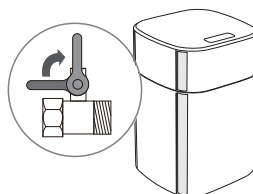

- ❗ When the device if faulty, please quickly cut off water supply, and contact the local service office or national wide service hotline.

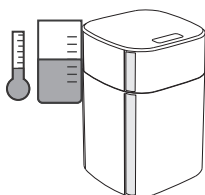

- ❗ When the environment temperature is low, the flow rate will drop, which is the natural property of the filter.

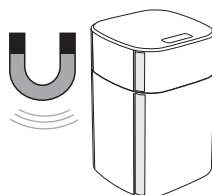

- ⊘ It may possibly cause fire, product damage or circuit fault if there's strong magnetic apparatus near the device

⊘ Mean the [prohibited] contents

❗ Mean the [compulsory] contents

⚠ [Note] The items which may possibly cause light injury or property loss

In order to ensure safe use and prevent physical injury and property loss for you and others, please obey the following cautions, otherwise, it may possibly cause accident.

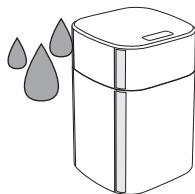

⊘ The damp or dusty environment may possibly cause device damages.

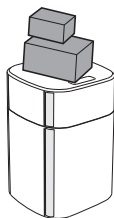

⊘ Please do not put heavy object on the device.

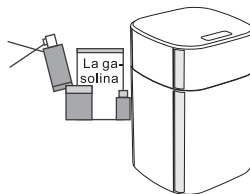

⊘ Please do not approach combustible and volatile substance to this device.

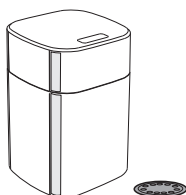

! Please install the device near the floor drain.



⊘ When there isn't water supply or the pipe is under repair, please turn off the three-way ball valve. After recovering water supply, please turn on other faucets to drain out sand and mud before turning on the three-way ball valve, otherwise, the filter may be possibly jammed by sand.

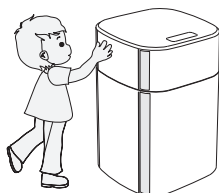

⚠ Children is not allowed to operate, contact, approach or climb on the product, children and intellectual disabilities should use the product with the support of guardian.



! Only the components provided by our company should be adopted.

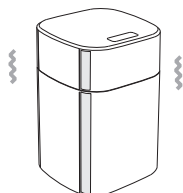

! It is normal that the product will vibrate and make noise lightly when it is producing water.

⊘ Mean the [prohibited] contents

! Mean the [compulsory] contents

⚠ [Note] The items which may possibly cause light injury or property loss

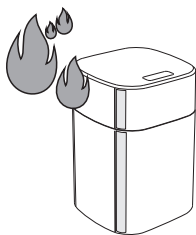

- ⊘ Please do not contact or approach the product to heat source and open fire.

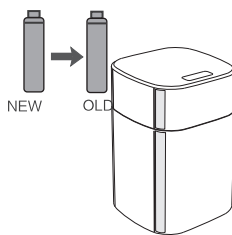

- ⚠ Periodically clean and replace the filter.

- ⊘ Mean the [prohibited] contents

- ⓘ Mean the [compulsory] contents

- ⚠ [Note] The items which may possibly cause light injury or property loss

E. FILTER CONFIGURATION

Filter Name	Functions	Filter Service Life	Quantity
PP cotton filter	Rough filtration for raw water, block the visible substances with naked eye in the raw water.	4-6 months	1 pcs
Front active carbon filter	Adsorb abnormal color, bad smell, residual chlorine and some organics (methenyl trichloride, carbon tetrachloride).	6 months	1 pcs
Ultrafiltration filter	Block the bacterium (total coliforms), visible substances with naked eye.	18 months	1 pcs
Rear active carbon filter	Adsorb abnormal color, bad smell, residual chlorine and some organics (methenyl trichloride, carbon tetrachloride) with better effect .	12 months	1 pcs

Special Instructions

1. The over-standard test for organics and heavy metals is conducted according to "Regulations on the Test of Drinking Water Hygiene and Safety Product of the Ministry of Health" .
2. The filter maintenance cycle is not the quality assurance period since it is the ideal filter maintenance period that the source water meets the drink water national standard basing on the normal water use of common family.
3. The maintenance cycle of filter is the estimated period, the actual maintenance cycle is different (according to the suggestion of local distribution and service office) according to the working area, water quality, using amount and season. Clean water may output after timely replacing the filter.

F. FILTER REPLACEMENT

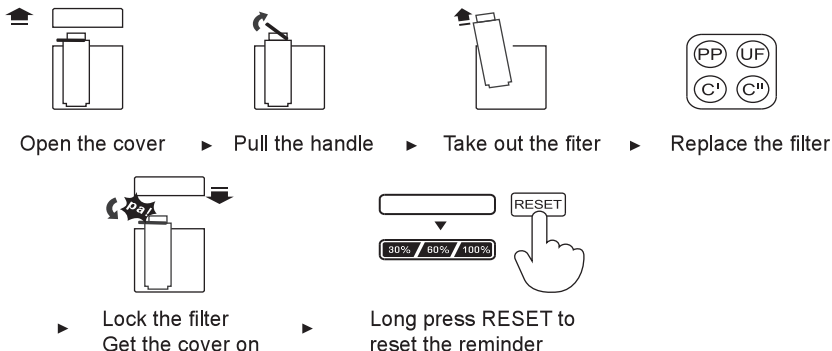

G. BASIC PARAMETERS

For the technical improvement of the product, the following parameters are subject to change without prior notice, please refer to the nameplate of the product.

The purified water flow rate is tested when the environment temperature $25\pm 2^{\circ}\text{C}$, water temperature $25\pm 1^{\circ}\text{C}$ and water inlet pressure $0.24 \pm 0.02\text{MPa}$.

Model	MUSP4W
Rated general purified water flow rate	3000L
Purified water flow rate	1.2L/min
Working pressure	0.1-0.4MPa
Applicable water quality	Municipal tap water
Working temperature	4-38 $^{\circ}\text{C}$

H. DAILY MAINTENANCE

Maintenance is necessary for the daily use of purified water, in order to avoid fault and hurting the drinking water safety caused by incorrect maintenance, and ensure the normal work of the product.

1. This product is periodically maintained by the professional technicians of our company, and the filters are replaced by our technicians for ensuring the quality of output water.
2. When cleaning the product, please do not use soap, detergent and strong volatile solvent such as thinner, gasoline and alcohol, otherwise, it may possibly cause crack, scratch and color changing.
3. Please do not directly spray water to clean the device.
4. Check if there's water surrounding the product, and identify if there's water leakage.
5. Check if the water outlet faucet has leakage.
6. Check if the concentrated water pipe is fixed tightly.
7. Before going out for a long period, check if the power is cut off and the inlet switch (three-way ball valve) is turned off.
8. Do not put the product declining, horizontal or upturned.
9. Do not refit the joint and pipe of the device by yourself.
10. Do not keep the product working in the environment lower than 0°C .
11. Do not disassemble and replace the filter by yourself.
12. Do not expose the product and pipeline in direct sunlight.

I. Water treatment process drawing

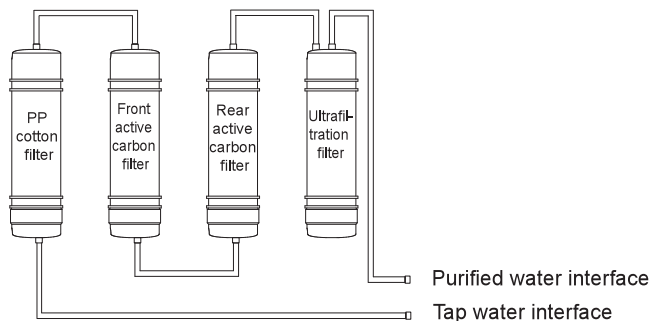

J. Check the Abnormal Phenomenon by Yourself

The followings are the identification and check of common abnormalities, if it can't be removed through simple treatment, please send it to the repair office or consult our customer service hotline. Do not dismantle and repair it by yourself for avoiding danger or water purifier damage.

1. During purifying and filtering process, the water purifier may generate light noise, please set your heart relaxed when it is working.
2. If there's any problem, please solve according to the following methods, if the fault can't be solved, please send the water purifier to local service office.

Phenomenon	Possible Reasons	Solutions
The water output volume of the purified water drops abnormally	Filter is jammed	Flush or replace the filter.
	Filter is not timely replaced and exceeds the service life	Replace the filter.
	The ball valve or faucet is not completely turned on	Check water inlet ball valve, or if the faucet is completed turned on.
	Purified water in the water storage tank is used up	Wait for the device to produce water, use it about half an hour later.
The output water quality is low	Filter is fault	Please contact local service office, and replace it timely.
	The device is not used for a long period (over 3 days)	Turn on the purified water faucet, flush it for 3-5min.
	Quality of source water is low	Confirm that water source is municipal tap water.
Water leakage	Component is damaged	Please cut off water and power supply, please send it to the repair office.
Not water output after replacing the filter	The pipe or filter is jammed	If the pipe is jammed, remove the obstacle; if the filter is jammed, replace the filter and try again.
After recovering tap water, turn on the purified water faucet doesn't output water	The pipe or filter is jammed	If the pipe is jammed, remove the obstacle; if the filter is jammed, replace the filter and try again.

The product is subject to change without notice.
Please keep this manual properly.