

Dimensions (unit:mm)

1.8-3.6kW

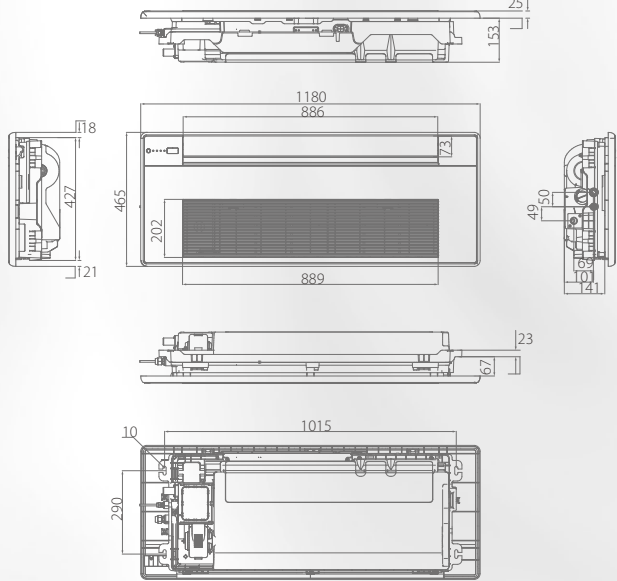

4.5-7.1kW

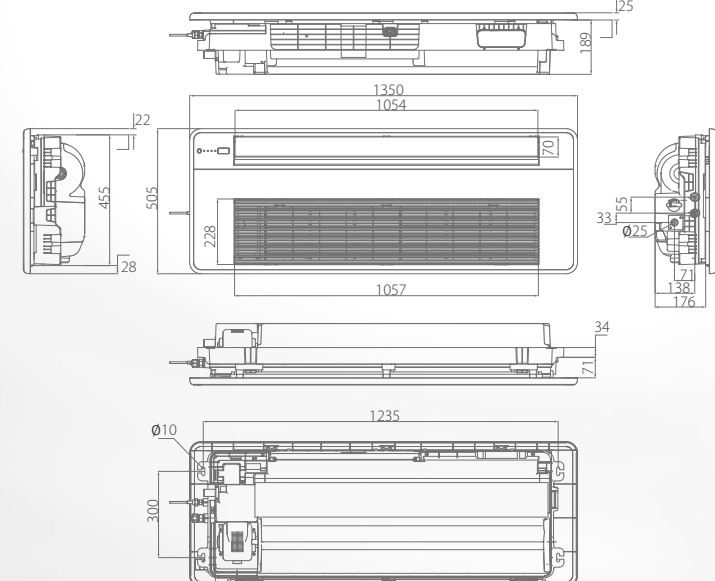

Specifications

Model			MIH18Q1HN18		MIH22Q1HN18		MIH28Q1HN18		MIH36Q1HN18		
Power supply			1-phase, 220-240V, 50/60Hz								
Cooling <sup>1</sup>	Capacity	kW	1.8		2.2		2.8		3.6		
		kBtu/h	6.1		7.5		9.6		12.3		
Heating <sup>2</sup>	Power input	W	25		25		30		30		
		kW	2.2		2.6		3.2		4.0		
	Capacity	kBtu/h	7.5		8.9		10.9		13.6		
		Power input	W	25		25		30		30	
Airflow rate <sup>3</sup>		m <sup>3</sup> /h	380/355/330/300/286/263/240					460/440/410/380/355/330/300			
Sound pressure level <sup>4</sup>		dB(A)	30/28/27/26/25/24/22					37/36/35/34/32/31/30		38/37/35/34/32/31/30	
Indoor unit	Net dimensions <sup>5</sup> (WxHxD)	mm	1054x153x428								
	Net dimensions (no water tray)(WxHxD)	mm	1054x141x428								
	Packed dimensions (WxHxD)	mm	1155x245x490								
	Net/Gross weight	kg	11.5/14.5					11.8/14.8			
Panel	Net dimensions (WxHxD)	mm	1180x25x465								
	Packed dimensions (WxHxD)	mm	1232x107x517								
	Net/Gross weight	kg	3.5/4.7								
Pipe connections	Liquid/Gas pipe	mm	Φ6.35/Φ12.7								
	Drain pipe	mm	OD Φ25								

Model			MIH45Q1HN18	MIH56Q1HN18	MIH71Q1HN18
Power supply			1-phase, 220-240V, 50/60Hz		
Cooling <sup>1</sup>	Capacity	kW	4.5	5.6	7.1
		kBtu/h	15.4	19.1	24.2
Heating <sup>2</sup>	Power input	W	40	48	60
	Capacity	kW	5.0	6.3	8.0
		kBtu/h	17.1	21.5	27.3
	Power input	W	40	48	60
Airflow rate <sup>3</sup>			693/662/638/600/556/510/476	792/763/728/688/643/589/549	933/873/815/749/689/637/592
Sound pressure level <sup>4</sup>			39/37/36/35/34/32/31	41/39/38/37/36/35/33	43/41/40/39/37/36/35
Indoor unit	Net dimensions <sup>5</sup> (WxHxD)	mm	1275x189x452		
	Net dimensions (no water tray)(WxHxD)	mm	1275x176x452		
	Packed dimensions (WxHxD)	mm	1370x295x505		
	Net/Gross weight	kg	15.8/20.2	15.8/20.2	16.9/21.4
Panel	Net dimensions (WxHxD)	mm	1350x25x505		
	Packed dimensions (WxHxD)	mm	1410x95x560		
	Net/Gross weight	kg	4/5.6		
Pipe connections	Liquid/Gas pipe	mm	Φ6.35/Φ12.7	Φ6.35/Φ12.7	Φ9.52/Φ15.9
	Drain pipe	mm	OD Φ25		

Notes:  
1. Indoor temperature 27°C DB, 19°C WB; outdoor temperature 35°C DB; equivalent refrigerant piping length 7.5m with zero level difference.  
2. Indoor temperature 20°C DB; outdoor temperature 7°C DB, 6°C WB; equivalent refrigerant piping length 7.5m with zero level difference.  
3. Each model's 7 airflow rate options are listed in order, from highest to lowest.  
4. Each model's 7 sound pressure levels are listed in order from highest to lowest and correspond to the model's 7 airflow rate options (see Note 3).  
5. Sound pressure level is measured 1.4m below the unit in a anechoic chamber.  
6. Unit body dimensions given are the largest external dimensions of the unit, including hanger attachments.  
7. These products are under development and the specifications are always subject to change.

Midea Building Technologies Division  
Midea Group

Add.: Midea Headquarters Building, 6 Midea Avenue, Shunde, Foshan, Guangdong, China  
Postal code: 528311

mbt.midea.com    www.midea-group.com    tsp.midea.com

Midea reserves the right to change the specifications of the product, and to withdraw or replace products without prior notification or public announcement. Midea is constantly developing and improving its products.



B-V8Q1H202305



V8 VRF Indoor Units  
One-way Cassette



DISCOVER  
RELIABLE COMFORT

# Why Choose V8 One-way Cassette Indoor Units



**True Feelings 1:** During the installation of VRF systems, errors often occur when connecting the communication line, often resulting in project delay

Support any topology communication\*  
In addition to the traditional daisy chain connection, the communication wire supports tree connection, star connection, ring connection and so on. The wiring is flexible, which greatly reduces the installation cost and has no possibility of wrong connection on site.

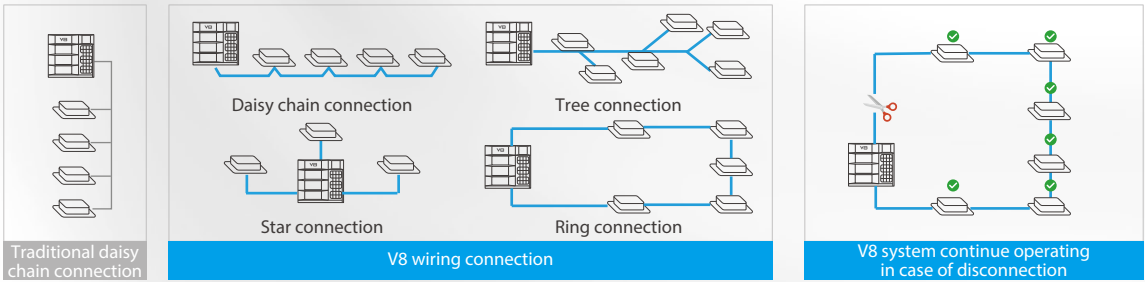

\*Only when use HyperLink communication.



**True Feelings 2:** I spent 200 days a year in other hotels because of business trips. The most troublesome thing was that I could not sleep because the air conditioner was too noisy at night.

**Quiet Operation**  
By optimizing the design of fan motor, air duct and heat exchanger, the new duct operates with noise as low as 22dB(A), creating a quieter and more comfortable environment





**True Feelings 3:** When using the air conditioner every summer, the air conditioner always drips water and causes the floor dirty.

**Automatic anti-condensation**  
The One-way Cassette can automatically enter and exit the anti-condensation mode by detecting its own operation data; In the anti-condensation mode, the machine can change the outlet angle of the guide vane intermittently to prevent the local temperature difference of the guide panel from being too large and avoid the occurrence of condensation.



# Features

**Auto Cooling-heating Changeover**  
Automatically selects cooling or heating mode to achieve the set temperature.

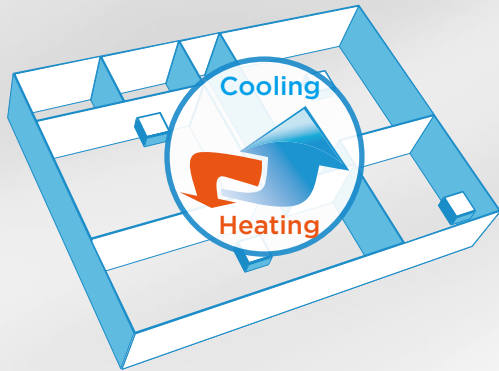

**Multiple Steps Vertical Swing**  
There are 5-steps louver control makes the air flow direction more precisely. In addition, the auto swing mode can better meet different customer needs. Air supply angle 25-80°.

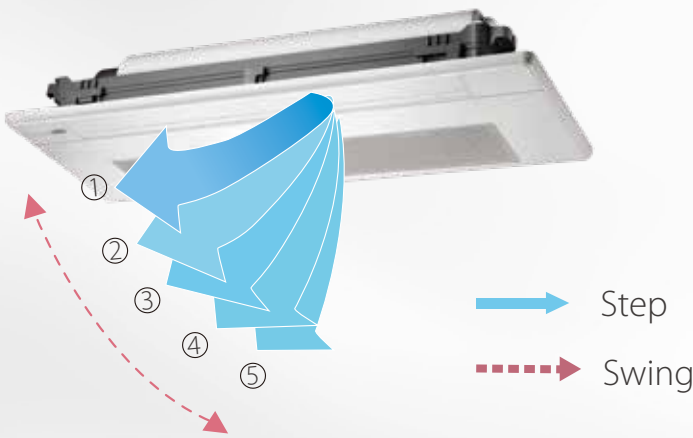

**Digital feedback DC water pump**  
Digital feedback DC water pump: actively sense the pump speed and water flow to determine whether there is jamming attenuation or damage, and give early warning to avoid water leakage.

