

Dimensions

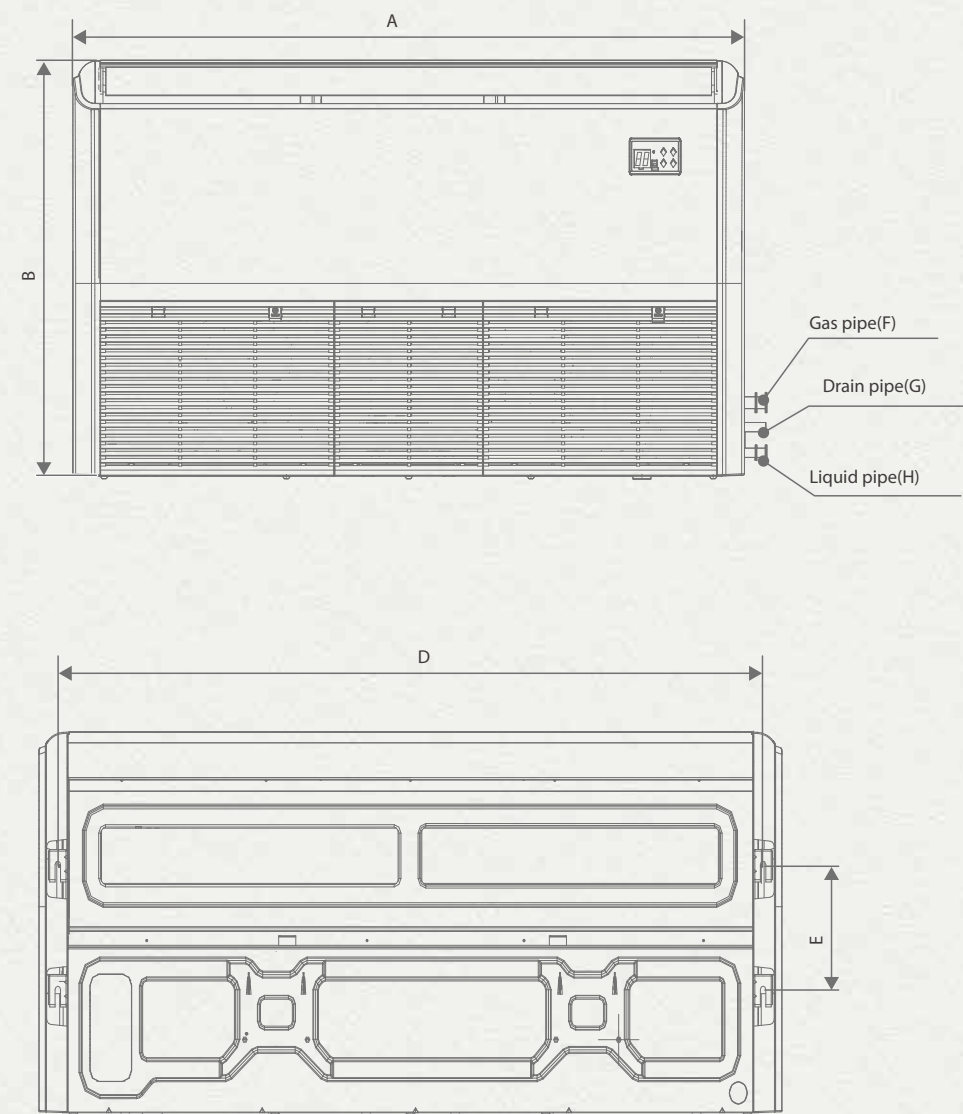

(Unit: mm)

Capacity (kW)	A	B	C	D	E	F	G	H
kW≤5.6	1069	674	234	984	221	Φ12.7	Φ25	Φ6.35
5.6<kW≤9.0	1284	674	234	1199	221	Φ15.9	Φ25	Φ9.52
9.0<kW≤14.0	1649	674	234	1565	221	Φ15.9	Φ25	Φ9.52

Midea Building Technologies Division
Midea Group

Add.: Midea Headquarters Building, 6 Midea Avenue, Shunde, Foshan, Guangdong, China
Postal code: 528311
mbt.midea.com www.midea-group.com tsp.midea.com
Midea reserves the right to change the specifications of the product, and to withdraw or replace products without prior notification or public announcement. Midea is constantly developing and improving its products.



B-V8DLH202310



V8 VRF Indoor Units
Ceiling & Floor



DISCOVER
RELIABLE COMFORT

Feature

Two Installation Options

A sleek design suits installation either on the ceiling or floor, providing flexibility to accommodate a wide range of room designs.



The unit can be installed either horizontally on the ceiling or vertically against the wall.

Quiet Operation

The fan motor and water pump* are DC power supply, which is more energy-saving and silent than AC power supply, creating a more quiet and comfortable environment



Fan Motor



Drain Pump

*Drain Pump is available as a customization option for unit

Auto Cooling-heating Changeover

Automatically selects cooling or heating mode to achieve the set temperature.

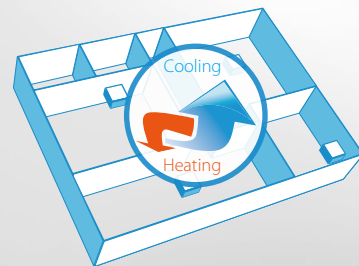

High-lift drain pump*

A drain pump with a 1200mm raise height is fitted as standard, simplifying installation of the drain piping.



*Drain Pump is available as a customization option for unit

Digital feedback DC water pump*

Digital feedback DC water pump: actively sense the pump speed and water flow to determine whether there is jamming attenuation or damage, and give early warning to avoid water leakage.

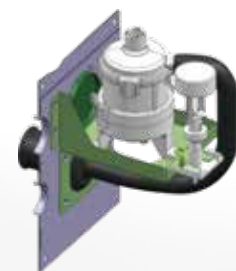

*Drain Pump is available as a customization option for unit

Multiple Steps Vertical Swing

There are 5-steps louver control makes the air flow direction more precisely. In addition, the auto swing mode can better meet different customer needs. Air supply angle 35-65 °.



Human Detect Sensor*

Using millimeter-wave radar sensor controller automatically turns indoor units on or off upon detecting that the room is occupied or unoccupied, ensuring climate control whilst minimizing energy consumption.

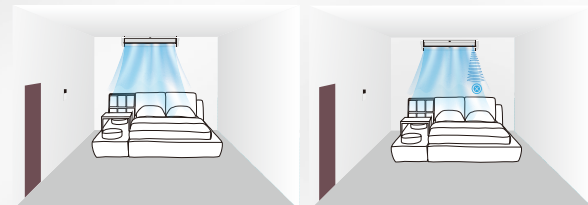

The indoor unit automatically runs when detecting human body
The indoor unit automatically stops when detecting absence

*This function is available as a customization option for unit.

Two thermistors control

The indoor temperature can be checked using the thermistor in the wried controller as well as from the indoor unit

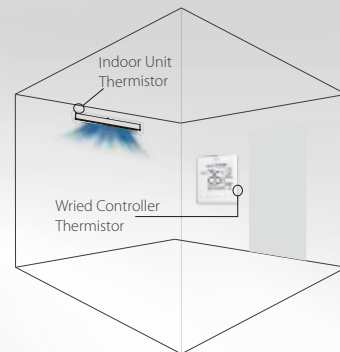

SPECIFICATION

Model name			MIH36DLHN18	MIH45DLHN18	MIH56DLNHN18	MIH71DLHN18	MIH80DLHN18
Power supply			1-phase, 220-240V, 50/60Hz				
Cooling ¹	Capacity	kW	3.6	4.5	5.6	7.1	8
		kBut/h	12.3	15.4	19.1	24.2	27.3
	Input	W	16	24	40	42	56
Heating ²	Capacity	kW	4	5	6.3	8	9
		kBut/h	13.7	17.1	21.5	27.3	30.7
	Input	W	16	24	40	42	56
Airflow rate ³		m³/h	564/539/514/492/ 467/445/424	712/674/637/603/ 565/531/500	927/883/840/794/ 751/707/665	1128/1062/1024/ 926/860/791/729	1300/1218/1138/ 1057/982/904/824
Sound pressure level ⁴		dB(A)	32/30/29/28/ 27/26/25	36/35/34/33/ 32/31/30	43/41/40/38/ 36/34/33	43/40/39/37/ 35/34/33	45/44/42/40/ 38/36/34
Sound power level		dB(A)	43/42/40/39/ 38/38/37	47/45/45/43/ 42/41/40	54/53/51/50/ 48/47/45	54/53/52/51/ 49/48/48	55/53/51/50/ 49/46/44
Unit	Net dimensions ⁵ (WxHxD)	mm	1069×674×234			1284×674×234	
	Packed dimensions (WxHxD)	mm	1190×755×313			1405×755×323	
	Net/Gross weight	kg	24.7/29.5	24.7/29.5	24.7/29.5	29.8/34.8	29.8/34.8
Refrigerant type			R410A/R32				
Design pressure (H/L)		MPa	4.4/1.5				
Pipe connections	Liquid/Gas pipe	mm	Φ6.35/Φ12.7			Φ9.52/Φ15.9	
	Drain pipe	mm	OD Φ25				

Model name			MIH90DLHN18	MIH100DLHN18	MIH112DLHN18	MIH125DLHN18	MIH140DLHN18
Power supply			1-phase, 220-240V, 50/60Hz				
Cooling ¹	Capacity	kW	9	10	11.2	12.5	14
		kBut/h	30.7	34.1	38.2	42.7	47.8
	Input	W	75	50	65	95	140
Heating ²	Capacity	kW	10	11.2	12.5	14	16
		kBut/h	34.1	38.2	42.7	47.8	54.6
	Input	W	75	50	65	95	140
Airflow rate ³		m³/h	1480/1397/1302/1218/1138/1056/979	1497/1469/1296/1200/1104/1015/918	1648/1530/1469/1292/1178/1067/956	2012/1879/1772/1649/1531/1469/1285	2206/2070/1937/1810/1677/1516/1402
Sound pressure level ⁴		dB(A)	48/47/46/44/42/40/37	42/40/39/37/35/33/32	44/42/41/39/37/35/33	49/48/46/44/42/40/38	51.5/50/48/46/44/42/40
Sound power level		dB(A)	58/57/55/54/52/50/49	54/53/51/50/48/46/44	56/54/53/51/49/47/45	60/59/58/56/54/53/51	63/62/60/58/56/54/53
Unit	Net dimensions ⁵ (WxHxD)	mm	1284×674×234	1649×674×234			
	Packed dimensions (WxHxD)	mm	1405×755×323	1770×755×323			
	Net/Gross weight	kg	29.8/34.8	36.4/42.7	36.4/42.7	36.4/42.7	36.4/42.7
Refrigerant type			R410A/R32				
Design pressure (H/L)		MPa	4.4/1.5				
Pipe connections	Liquid/Gas pipe	mm	Φ9.52/Φ15.9				
	Drain pipe	mm	OD Φ25				

Notes:
1.Indoor temperature 27°C DB, 19°C WB; outdoor temperature 35°C DB; equivalent refrigerant piping length 7.5m with zero level difference.
2.Indoor temperature 20°C DB; outdoor temperature 7°C DB, 6°C WB; equivalent refrigerant piping length 7.5m with zero level difference.
3.Fan motor speed and air flow rate are from the highest speed to the lowest speed, total 7 rates for each model.
4.Sound pressure level is from highest level to lowest level, total 7 levels for each model. Sound pressure level is measured 1.5m below the unit in a semi-anechoic chamber.
5.The dimension is only the body size, excluding the size of the installation lug, connecting copper pipe, etc. For detailed dimensions, please refer to the installation manual.